

# Mountain Park Place

Flex/Industrial  
For Lease

1785 - 1835 East Park Place Boulevard  
Stone Mountain, GA 30087  
(Gwinnett County)

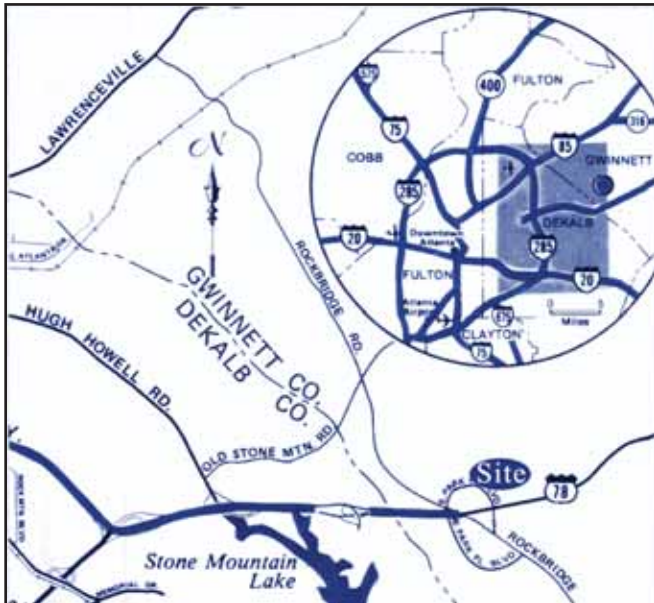

**Space Available:** 1,700 – 4,124 sf

## Project Highlights:

- High visibility on four-lane road
- Less than half mile to Stone Mountain Parkway/US 78
- Office park features 2 single story brick buildings totaling 54,433 SF
- Drive-in doors available
- Move-in Ready Suites
- Flexible Lease Terms
- 24 Hour Access
- Tenant Controlled HVAC
- C-3 Zoning
- Existing tenants include:

CitiFinancial  
Coleman, DDS  
Financial Mortgage Solutions  
CrossRoad Carriers  
NCA Buchanan  
B&C Computer

U.S. Postal Service  
Buckhead Real Estate Group  
Innovative Learning Concepts  
Lane Multi-Print  
Price and Associates  
Pendergrass & Ramsey

## Ackerman & Co.

For more information, please contact:

**Josh Gregory**

770-913-3943

[jgregory@ackermanco.net](mailto:jgregory@ackermanco.net)

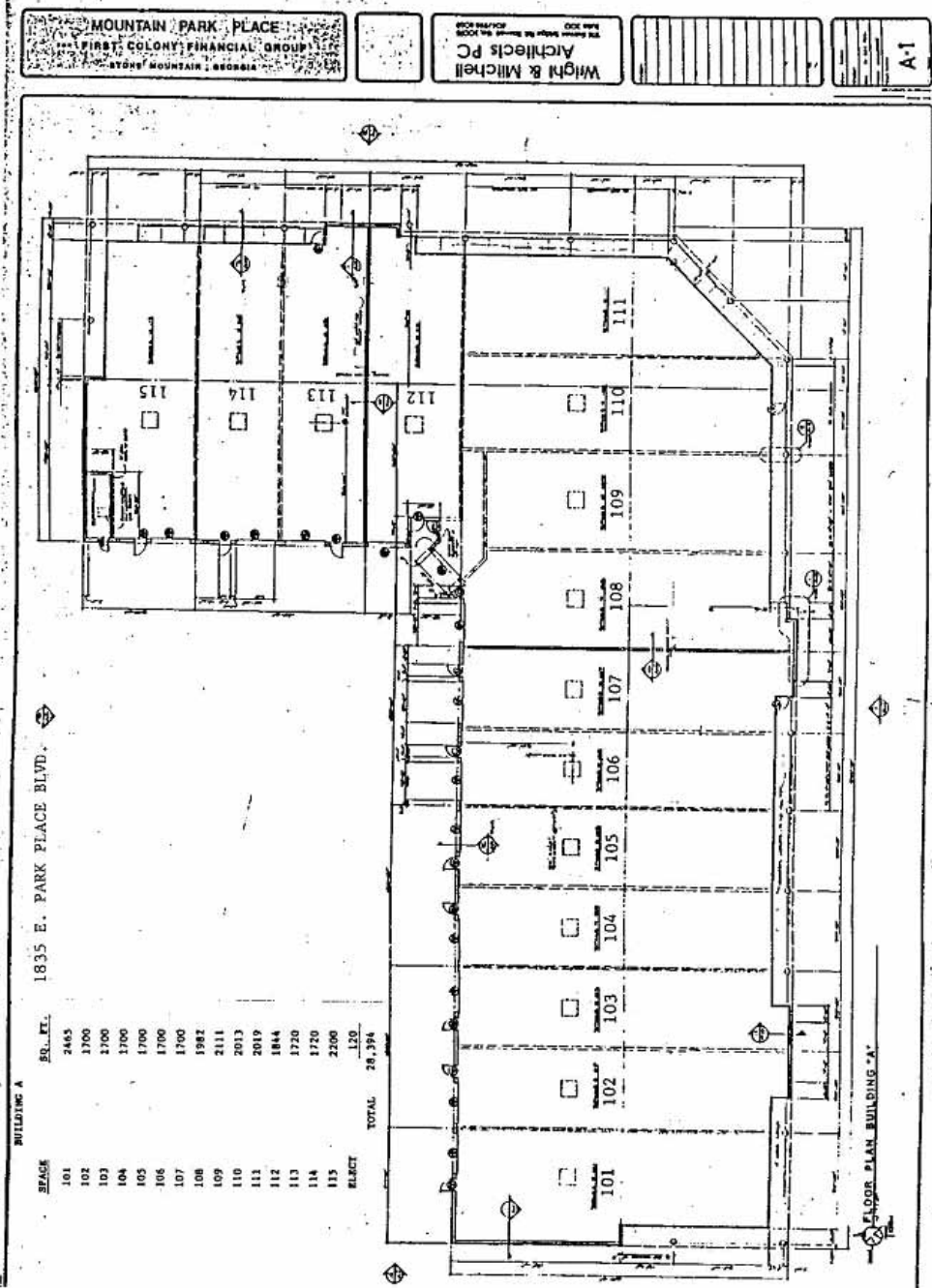

# Ackerman & Co.

## Mountain Park Place

Space Available: 1,700 - 4,124 sf