

3760 Peachtree Crest Dr.

Office/
Industrial
For Sale

3760 Peachtree Crest Drive
Duluth, GA 30097
(Gwinnett County)



Project Highlights:

- \$2.25MM
- 30,000 sf building (55% leased)
- 14,000 sf available

Available Suite Details:

- 14,000 sf total
- 11,000 sf office & 3,000 sf warehouse
- Data room with dedicated HVAC
- 2 break rooms
- Upgraded finishes
- Perfect for owner/user
- Well suited for call center, sales office, training center
- Owner financing available
- Also available for lease or lease/purchase

Ackerman & Co.

For more information, please contact:

Shea Meddin

770-913-3992

smeddin@ackermanco.net

Harris Tessler

770-913-3947

htessler@ackermanco.net



Ackerman & Co.

3760 Peachtree Crest Dr.

Space Available: Space Available: 14,000 sf

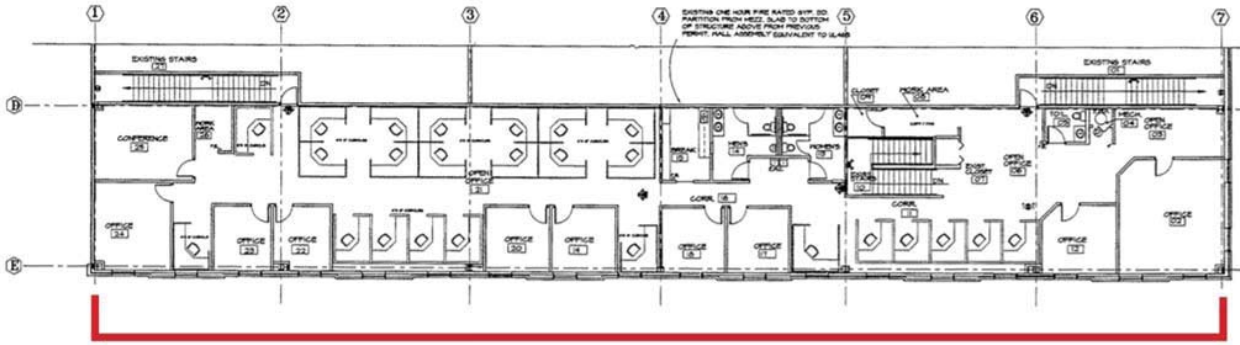

SUITE A - MEZZANINE LEVEL

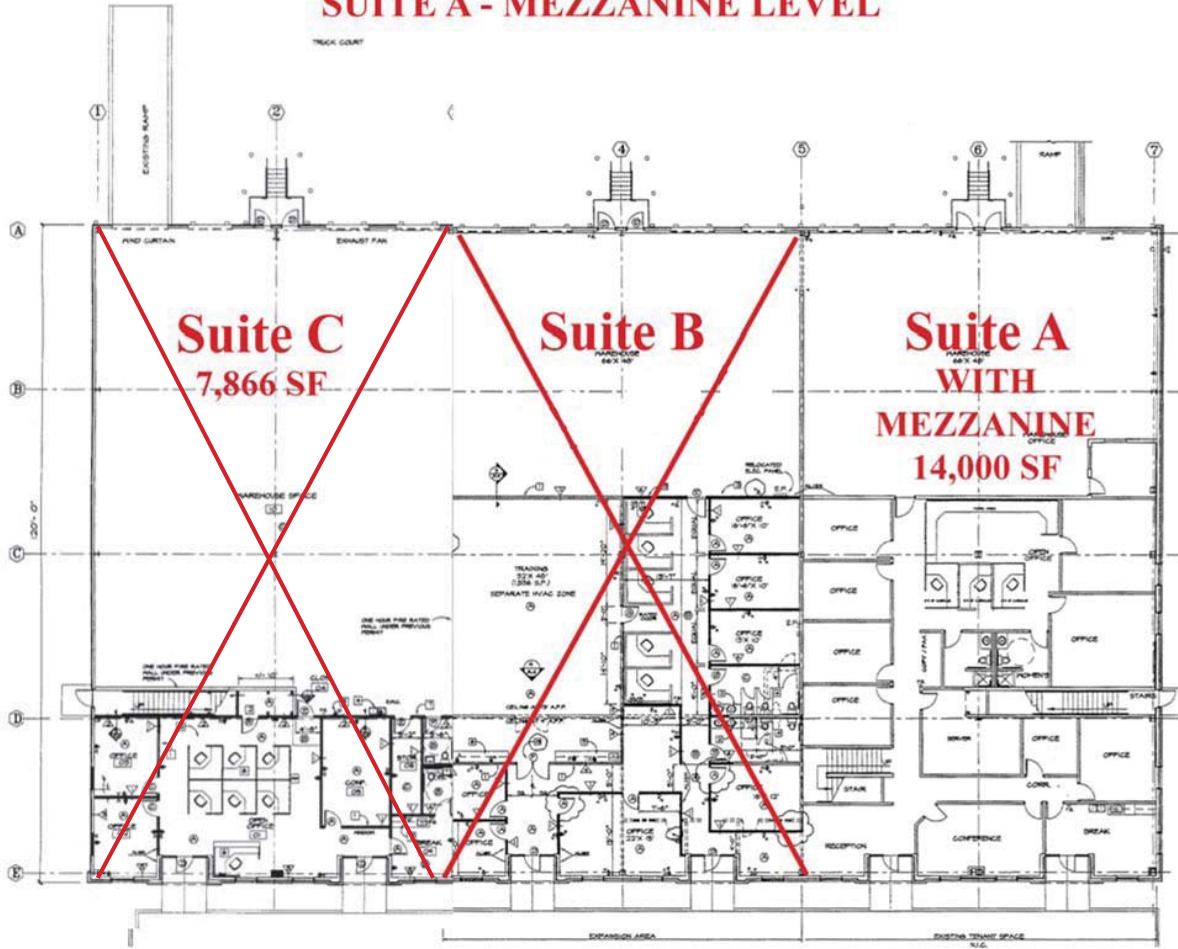

MAIN LEVEL

Ackerman & Co.

Space Available: 14,000 sf

3760 Peachtree Crest Dr.